

4" x 5.65" Matte Box 29 (MB-29)



CONFIGURATION OVERVIEW – 7.9.0 / 2010.07

© 2010 Arnold & Richter Cine Technik GmbH & Co. Betriebs KG. All rights reserved. This material is provided "as is" for information purposes only without any warranty. ARRI assumes no responsibility with regard to the performance or use of the products or typographical errors or inaccuracies of given information. Product specifications are subject to change without notice. For a full listing of all available components consult the price list.

Set Configurations



Set K0.60113.0
includes:
Base Module (K2.66035.0),
Filter Stage, rear only rotatable (K2.66017.0),
Swing away module (K2.66015.0),
Lightweight support (K2.65025.0),
4"x5.65" Horizontal Tray (K2.47669.0),
4"x5.65" rear Stage Tray (K4.47493.0),



Set K0.60114.0
includes:
Base Module (K2.66035.0),
Filter Stage, both rotatable (K2.66018.0),
Swing away module (K2.66015.0),
Lightweight support (K2.65025.0),
Combo 4"x5.65" Horizontal/Vertical and 5"x5" (K2.66037.0),

Filter frames

For Filter Stage
K2.66017.0



- 4" x 5,65" Filter frame, horizontal K2.47669.0
- 4" x 5,65 Filter frame, rearstage K4.47493.0
- 4" x 4" Filter frame K2.47104.0
- 4" x 4" Filter frame, rearstage K2.47105.0

For Filter Stage
K2.66018.0
K2.66118.0
K2.66119.0



- 4" x 5,65" / 5" x 5" Filter frame, K2.66037.0
- 4" x 5,65" / 4" x 4" Filter frame, K2.65230.0
- 5,65" x 5,65" Filter frame, K2.66036.0

Hard Matte Sets 16:9
K2.66107.0

Hard Matte Sets 35
K2.66108.0

Light Protection

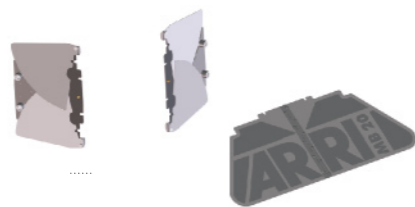

Top flag, K2.47740.0
Bottom flag, K2.47740.0
Side flag (pair), K0.60029.0

Basic Modules & Accessories



**MB-29
Basic Module
with Sunshade**
K2.66035.0

Clamp Module
K2.66016.0



**Filter Stage
for 2 Filter,
rear only rotatable
(as MB-19)**
K2.66017.0



**Filter Stage
for 2 Filter,
both rotatable**
K2.66018.0



**Filter Stage
for 3 Filter,**
K2.66118.0



**Filter Stage
for 4 Filter,**
K2.66119.0



**Swing away
module MB- 29**
K2.66015.0



**Console for
lightweight support**
K2.65025.0
(requires swingaway
module)

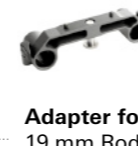

**Adapter for
19 mm Rods**
K2.47101.0
**Adapter for
15 mm Rods**
K2.47102.0

R2 Filter Rings



Adapter ring R2-R3
allows use of R3 filter rings
K2.47115.0



**Large Diameter Wide-Angle
Light Trap Rings** (not for clamp
on ring) reducing filter diameter
from 138 mm to listed diameter
K2.65069.0 (ø 117 mm)
K2.65070.0 (ø 120 mm)
K2.65123.0 (ø 121 mm)
K2.65071.0 (ø 128 mm)*
*not for Fujinon 3 x 5 HAe
Super Zoom)
K2.65090.0 (ø 128 mm)*
*for Fujinon 3 x 5 HAe Super
Zoom)
K2.65072.0 (ø 130 mm)
K2.65073.0 (ø 132mm)



Adapter Ring
reduces filter diameter from
138 mm to 114 mm (4½")
K2.49099.0



138 mm filter ring
K2.52204.0 (ø 114 mm)



138 mm filter ring
K2.47222.0* (ø 100 mm)

* discontinued items, only as long
as stock is available

R3 Filter Rings

**CAUTION: CAN VIGNETTE.
PLEASE CONTACT ARRI.**



4½" (114 mm) filter ring
K2.49109.0 (ø 87 mm)



Reduction ring (R6)
K2.47226.0 (ø 80 mm)



4½" (114 mm) filter ring
K2.49102.0 (ø 95 mm)



Reflex prevention ring
K2.32911.0 (ø 125 mm)



4½" (114 mm) filter ring
K2.52205.0 (ø 114 mm)

R4, R5 Reduction Rings

Video Connection Rings



Reduction rings (R4 | 114 mm)
K2.65055.0 (ø 96 mm)
K2.65044.0 (ø 98 mm)
K2.65046.0 (ø 100 mm)
K2.52195.0 (ø 104 mm)
K2.65096.0 (ø 105 mm)
K2.65045.0 (ø 110 mm)



Reduction rings (R8 | 150 mm)
K2.66073.0 (ø 130 mm)
K2.66074.0 (ø 128 mm)
K2.66075.0 (ø 125 mm)
K2.66076.0 (ø 121 mm)
K2.66077.0 (ø 120 mm)
K2.66078.0 (ø 117 mm)



Reduction rings (R5 | 100 mm)
K2.65043.0 (ø 80 mm)
K2.65038.0 (ø 85 mm)
K2.65039.0 (ø 86 mm)
K2.47225.0 (ø 87 mm)
K2.65040.0 (ø 90 mm)
K2.65054.0 (ø 92 mm)
K2.47224.0 (ø 95 mm)
K2.65029.0 (ø 95 mm WA)*
(WA =wide angle)

**Note: only for wide angle lenses
with cutouts (4.9 mm and below)**
For lenses larger than 4.9 mm
use K2.47224.0

ø = diameter of connection ring to lens